

## Šumavská Tower

Šumavská 32, Brno

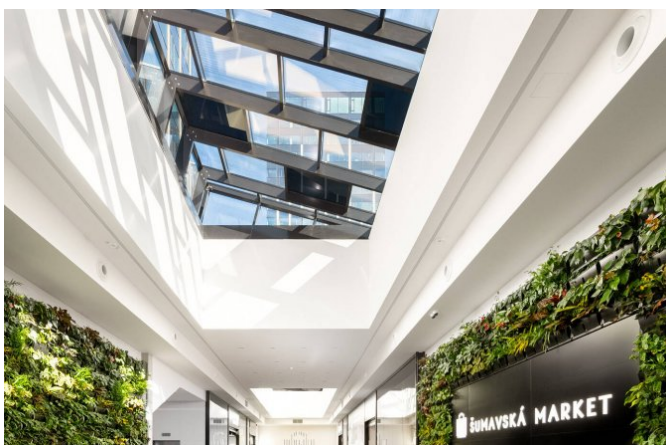

Price

from 10.50 Eur/m<sup>2</sup>

Offer type

# lease

Unit area

240 - 6 720 m<sup>2</sup>

Total available area

10 834 m<sup>2</sup>

## Description

The building has 22 floors above ground, 2 underground floors, 3 elevators, barrier-free access, and office space from the area of 200 m<sup>2</sup>. The area of the entire typical floor is 483 m<sup>2</sup>. It has a new all-glass facade with openable windows, energy-saving and ecological heating/cooling of the building, toilet and shower, kitchenette, reception services, building security 24/7, movement around the building with chip cards, parking in 2 underground floors with a capacity of up to 550 seats.

## Parameters

Number of floors above ground	22
Total available area	10 834 m <sup>2</sup>
Parking place	
Building approval	2020
Energy efficiency	B
Quality	A

## Equipment and services

Air conditioning	✓
Správa budovy v objektu	
Carpets	✓
Conference room	
PC/data network	
Double floor	✓
Fire alarm	
Internal blinds	✓

Kitchen	
Lift	✓
Lowered ceiling	✓
Magnetic card entry	✓
Openable windows	✓
Optical cable	
Parking	✓
Telephone network/lines	
Recepce	✓
Restaurant/canteen	✓
Security	✓
Smoke detector	✓
Sprinklers	✓
Terraces	
Private toilet	

## Available variants

10.50 - 12.90 Eur/m <sup>2</sup>	lease 240 m <sup>2</sup>	1 <sup>st</sup> floor
10.50 - 12.90 Eur/m <sup>2</sup>	lease 490 m <sup>2</sup>	10 <sup>th</sup> floor
10.50 - 12.90 Eur/m <sup>2</sup>	lease 483 m <sup>2</sup>	11 <sup>th</sup> floor
10.50 - 12.90 Eur/m <sup>2</sup>	lease 483 m <sup>2</sup>	23 <sup>rd</sup> floor
10.50 - 12.90 Eur/m <sup>2</sup>	lease 6 720 m <sup>2</sup>	

10.50 - 12.90 Eur/m <sup>2</sup>	lease 483 m <sup>2</sup>	12 <sup>th</sup> floor
10.50 - 12.90 Eur/m <sup>2</sup>	lease 486 m <sup>2</sup>	18 <sup>th</sup> floor
10.50 - 12.90 Eur/m <sup>2</sup>	lease 483 m <sup>2</sup>	13 <sup>th</sup> floor
10.50 - 12.90 Eur/m <sup>2</sup>	lease 483 m <sup>2</sup>	15 <sup>th</sup> floor
10.50 - 12.90 Eur/m <sup>2</sup>	lease 483 m <sup>2</sup>	20 <sup>th</sup> floor

## Contact the broker



Jan Novák  
+420 222 242 342  
[info@officeportal.cz](mailto:info@officeportal.cz)

Portal Jungle s.r.o., Václavské náměstí 841/3, 110 00 Praha 1, IČ: 0763750, DIČ: CZ07613750  
2020 © Portal Jungle, s.r.o. Všechna práva vyhrazena.